

EMERGENCY LIGHTING LUMINAIRE INSTRUCTIONS & TEST PROCEDURES

RECOMMENDED ROUTINE TEST PROCEDURE

The following test is designed to ensure the continued protection of your premises and occupants. Because of the possibility of a failure of the normal lighting supply occurring shortly after a period of testing, all tests should, whenever possible, be undertaken at times of least risk, e.g. during daylight hours.

ONCE A DAY

Visual inspection of battery charge led.

ONCE A MONTH

Each unit should be energised from it's battery for adequate time to ensure, by simulation of a failure of the normal lighting supply, the emergency mode is functioning correctly.

ONCE EACH YEAR

All units should be placed into emergency mode and checked that the duration provided by the battery meets the specified time period.

Azelio Range

Input Voltage Range Input Frequency Range	220-240V 50/60Hz
Power Factor	0.25
Power Consumption (Mains)	2W
Light source	SMD LED
LED wattage	3W LED/1PCS
Lumen Output – Emergency Mode	E/AZELIO/C: 197 lm
	E/AZELIO/OA: 219lm
Operating Temperature Range	0°C-40°C
Battery Type and Specification	Lithium battery 3.7V 2600mAh
Charging Time	24hours
Discharge Time	More than 3hours
Colour Temperature	6000K-7000K
Deep Discharge Protection Voltage	3V
Overcharged protection voltage	4V
Dimensions	Φ110X108mm
Weight	E/AZELIO/C: 282g
	E/AZELIO/OA: 280g
Cut Out	Φ95-100mm
IP Rating	IP20
IEC protection classes	Class 1

This equipment should be installed by a competent electrician

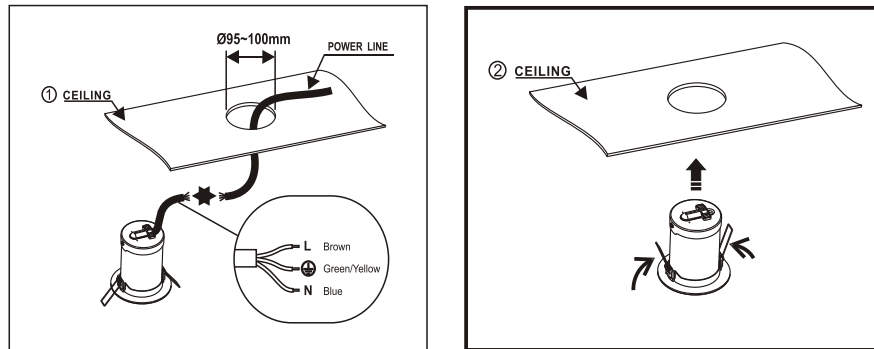

1. Install in to ceiling using spring clips
2. ISOLATE THE A.C. SUPPLY and connect unit. An unswitched 240 V A.C. supply from the local lighting circuit must be connected to the Live (L), Earth and Neutral (N) wires.
3. Operational Check - Restore the A.C. supply for 30 minutes and then isolate. The LEDs should illuminate for at least 10 seconds.
4. Restore the A.C. supply and check that the charge indicator LED is 'on'.

OPERATION

NON-MAINTAINED

LEDs normally off and battery on automatic charge (Charge LED 'on') when A.C. supply is healthy. Solid state circuitry automatically switches LEDs on when A.C. supply is interrupted.

FAULT FINDING AND CORRECTIVE ACTION

MONITORING LED NOT ILLUMINATED

A.C. supply not healthy. Battery not connected. Charger failed.

UNIT NOT MEETING REQUIRED EMERGENCY PERIOD

May need cycling: Discharge then recharge for 24 hours. Re-test, battery pack may need replacing if emergency duration still not met.

