

Lighting the way ahead with 3 emergency light testing solutions

Option 1: Stand alone self test

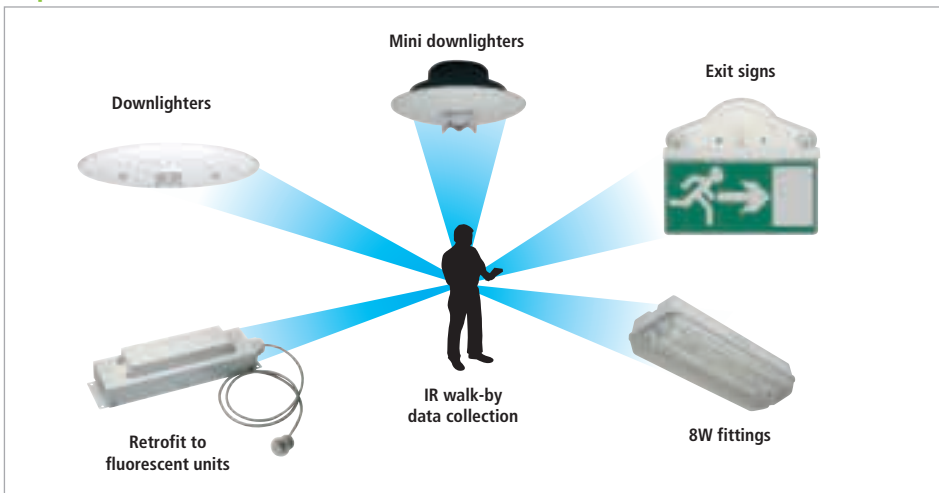

Option 2: Infra-red data collection



Option 3: Wired data collection

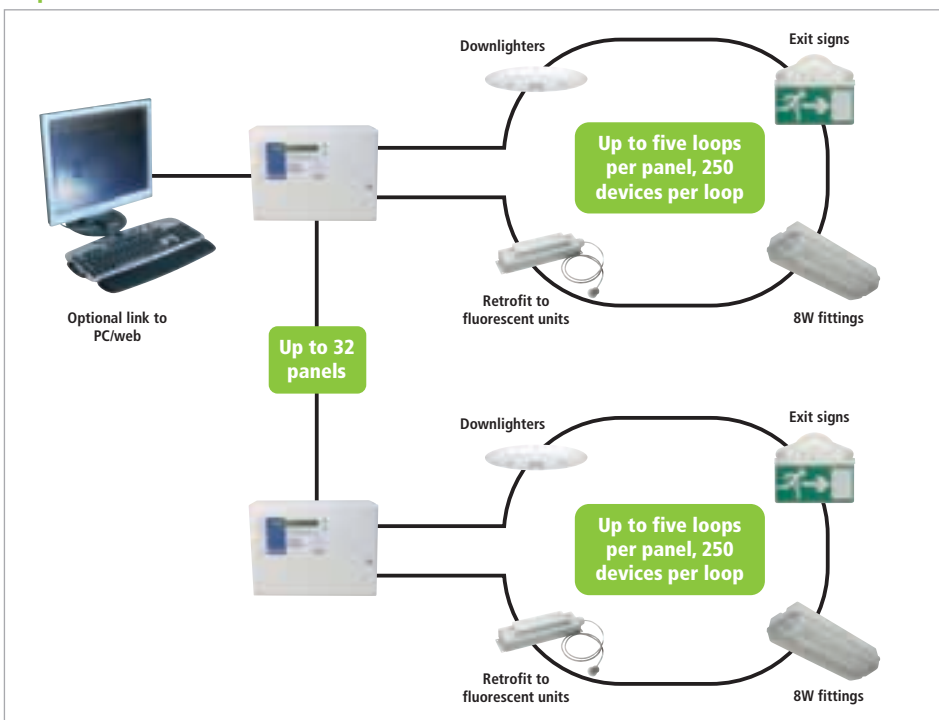

WHY IS ELITE DIFFERENT?

The system has been designed with the installer and the end-user in mind. With a focus on compliance, reduced cost of ownership and an enhanced feature set, it lights the way ahead in the emergency lighting industry.

- Automatic testing to BS5266
- Extended in-service life
- Low environmental impact

UNIQUE FEATURE SET

LED corridor or open area & exit sign fittings
8W 'conventional' emergency lights

WHAT THIS MEANS FOR THE END USER

- Helps you to meet your legal obligations under Health & Safety guidelines
- Guarantees testing is carried out thoroughly and on time
- Accurately logs all test result data
- Reduces your cost of maintenance

WHY LED FITTINGS?

Extended life

- Latest technology solid state electronic light source provides up to 60,000hrs of continuous operation (fluorescent lamp 3-15,000hrs).
- Latest in Lithium Ion battery technology provides up to 60,000hrs of active life. (Conversion kits also use Lithium Ion).

REDUCED COST OF OWNERSHIP

- With the LED range, lamp replacement becomes a thing of the past.
- Reduced disruption to normal business activities due to maintenance work.
- No recycling costs associated with fluorescent lamps.
- Reduced energy bills.
- Reduced carbon footprint.
- Reduced contribution to global pollution.

LOW ENVIRONMENTAL IMPACT

- WEEE and RoHS compliant.
- Recyclable materials used in construction.
- Lead free components.
- Lithium Ion batteries do not contain dangerous substances as defined in EU directives.
- Solid state light source does not contain mercury and it is estimated that it uses less than 1% of the energy needed to make a fluorescent lamp.
- LED lights use 98% less energy throughout their operating life. (When compared with an 8W fluorescent lamp with NiCad batteries).

ELITE – Emergency Lighting Intelligent Test Equipment

UNIQUE FEATURE SET

- One unit with interchangeable lenses for corridor, open space and wall mount applications
- 1st fix plate for easy installation
- Common base unit for surface or flush mounting
- Simple removal mechanism
- One piece removal of electronics, battery and light source without the need to disconnect wires
- Integral green and red status LEDs

LIGHTING THE WAY AHEAD!

- Integral fault warning buzzer. (In stand alone mode)
- Remote test and fault diagnostics
- A unique address for each device with auto-address capability
- Monitoring of internal components – light source, mains power, battery charger, battery and internal temperature
- Holds last 36 test results in memory

UNIQUE FEATURE SET

Option 1: Stand-alone. 'self-test'

Option 2: IR data collection

- By addition of IR Data Tablet Hand-held tool collects data via infra-red link
- Can transfer it to a PC for analysis, record keeping and planned maintenance activities

Option 3: Central test using ELITE control panel

- Modular panel with 1 to 5 loops
- Supports ELITE protocol – up to 250 addresses per loop
- Supports a 2Km loop using a 2x0.7mm screened cable
- Maximum cable resistance 40Ω/Km
- PC based graphical user interface for large system applications
- PC based graphical user interface for large system applications
- Single or multiple building capability



Recessed Exit Sign



Surface Exit Sign



Standard flush mounted LED fitting (Corridor unit shown)



Standard open area LED fitting



Standard surface mounted LED fitting



Mini LED downlighter with choice of Silver, Brass or White Bezel



8W fluorescent version available



Simple time saving installation

RRO - Why Me!

Disabled woman wins case against tea shop owner

When Jazz Shaban, who has brittle bones and uses a wheelchair, tried to visit Wharfe's Restaurant and Tea Room, in Shaftesbury, Dorset, she and her friend wanted to use the downstairs seating area, which is accessed via two steps. They immediately faced resistance from the tea shop owner, Rosemary Wharfe, who shouted: 'Not in here, we cannot accommodate that.' Although Wharfe did not turn up in court, District Judge Smith ruled that this was 'the clearest possible case of discrimination', and awarded Shaban **£4,500** in compensation.

Sir Bert Massie, Chairman of the former Disability Rights Commission (DRC), voiced his feelings about the case when he said: 'This is a very significant result and should send out a strong message that such discriminatory and aggressive behaviour is unlawful and will not be tolerated. Small businesses are not exempt from the law and disabled people have every right to be treated with dignity and respect.'